

# XSERIES RV

# XWARRIOR

## NEW X-SERIES HAS ARRIVED

### 16FT HARD ROOF HYBRID CARAVAN

FAMILY SIZED & READY FOR ADVENTURE!  
ON OR OFF-ROAD, THE CHOICE IS YOURS.

All the essentials already included & a setup which could not be easier, you can have it all with this Hybrid Caravan.

The interior layout is streamlined & loaded with all the features you love, such as interior cooking facilities, leatherette lounge space which converts to a bed, internal built in fridge as well as a complete ensuite room with shower & toilet.

The usual upgrades are included with this unit like Gas & 240v connections, Air Conditioning & dual roof mounted solar panels.

It also features a REDARC Power management system with inverter to give you the control over your lithium batteries at all times.



[XSERIESRV.COM.AU](http://XSERIESRV.COM.AU)

FOLLOW US    X SERIES RV AUSTRALIA



CAPACITY:  
2 ADULTS  
3 CHILDREN





## CHASSIS

Tare 2230kg* Ball Weight 250kg*	●
Drawbar Tube Size 150mm x 50mm x 4mm Hot Dip Galvanised	●
16" Mud Terrain Tyres with 1 Spare Included	●
Alloy Rims	●
Heavy Duty Removable Jockey Wheel	●
Do35 Hitch with Receiver Coupling	●
12" Electric Brakes & Manual Handbrake	●

## SUSPENSION

Off Road Independent Suspension System	●
Heavy Duty Coil Springs & Shock Absorbers	●

## STORAGE

1 x Large Front Toolbox	●
Dedicated Fridge Slides with Power Supply	●
12+ Interior Storage Cupboards & Drawers	●
2 x 9kg Gas Bottle Holders	●

## KITCHEN & BATHROOM

Interior & Exterior Thetford 3 Burner Cooktops with Lighting & Gas Plumbing Connections.	●
2 x 95L Fresh Water Tanks	●
125L Grey Water Tank	●
Interior Built in Fridge / Freezer	●
Interior Built in Microwave	●
Installed On Board Gas/Elec Hot Water Unit	●
External Shower Outlet	●
Thetford Cassette Toilet	●
Full Size Mirror on Ensuite Entry Door	●
Interior Ensuite Shower Room with Movable Rose Head, Corner Sink, Roof Ventilation, LED Lighting & Mirror	●

## SAFETY

Fire Extinguisher Included	●
ADR Approved Safety Chains & Coupling	●
Dual Internal Smoke and Carbon Monoxide Alarms	●
Reversing Camera Included	●

## EXTERIOR GENERAL

Fibreglass Body with Aluminum Internal Frame	●
Black Heavy Duty Lower Body Coating	●
Entry Door with Separate Screen Door	●
3.9m x 2.3m Electric Sunshade Awning with LED Lighting	●
Fold Down Serving/Picnic Bench with Lighting	●

## INTERIOR GENERAL

Multimedia Touch Screen Stereo System & 24" Smart TV	●
Dometic Dual System Heating & Cooling Air Conditioner & Diesel Heater	●
Internal & External LED Lighting Throughout	●
Queen Size Main Bed	●
Dual Single Bunks at Front with Built In Ladder	●
Converting Lounge to Single Bed Space	●
Windows with Block Out & Fly Screen Panels	●
Wood Printed Vinyl Flooring	●
Grey Cabinetry Finishings with Black Handles	●
Built In Sky Light Hatch with LED Lighting	●
Interior & Exterior Speakers	●

## POWER

REDARC Battery Management System with Solar Reg, Charging, & Bluetooth Controls	●
Anderson Plug Car Connections	●
2 x 150ah Lithium Batteries	●
Dual 200w Roof Mounted Solar Panels	●
3000 WATT - 12v / 240v Inverter System	●
240V Connection with Multiple GPO Points	●
Multiple 12V Sockets with Dedicated Fridge Sockets	●

## CAMPING ACCESSORIES

62L Dual Zone Fridge Freezer	○
2KVA Generator	○

● Standard ○ Optional Upgrades

\* Data accurate at time of print, please visit website product listing for more unit specifications & most current information.

\*\* Weights are indicative and subject to change. The build specification will change the weight. Actual weights will be displayed on compliance plates at time of build. Pods only have diesel heater but other models have both Dometic aircon/diesel heaters

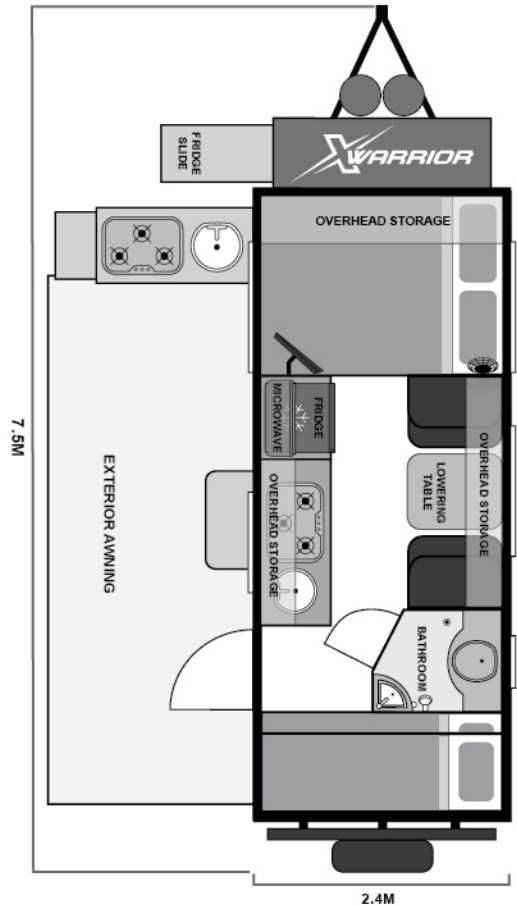

SIZE CLOSED - INCLUDES A/C  
Length 7.5m - Width 2.4m - Height 3.1m



ATM  
APPROX.  
2850KG



TARE  
APPROX.  
2230KG



BALL WEIGHT  
APPROX.  
250KG



CHARGER SYSTEM  
REDARC POWER  
SYSTEM & INVERTER



BATTERY  
2 x 150AH  
LITHIUM



POWER  
240V CONNECTION  
INCLUDED



WATER TANKS  
2 x 95L CLEAN  
1 x 125L GREY



HEATING & COOLING  
DOMETIC DUAL SYSTEM  
INC. & DIESEL HEATER



CAPACITY  
2 ADULTS  
3 CHILDREN



GAS HOLDERS  
2 x 9KG GAS