

XSERIES RV

X NAVIGATOR

NEW X-SERIES HAS ARRIVED

17FT HARD ROOF HYBRID CARAVAN

A HYBRID FOR COUPLES & SMALL FAMILIES
WITH ALL THE LUXURIES OF HOME.

This unit truly embodies Luxury camping & off-road capabilities in a beautiful package to delivery a Royal experience.

The spacious layout accommodates couples with ease & the converting lounge space is perfect for a little one or fluffy companion to join your adventures.

The opulence of this van is evident with its luxury amenities such as the washing machine & split ensuite space with privacy separating door as well as island style bed with surrounding cabinetry & additional under bed space.



XSERIESRV.COM.AU

FOLLOW US



X SERIES RV AUSTRALIA



CAPACITY:
2 ADULTS
1 CHILD



CHASSIS

| | |
|--|---|
| Tare 2300kg* Ball Weight 200kg* | ● |
| Drawbar Tube Size 150mm x 50mm x 4mm Hot Dip Galvanised | ● |
| 16" Mud Terrain Tyres with 1 Spare Included | ● |
| Alloy Rims | ● |
| Heavy Duty Jockey Wheel | ● |
| Do35 Hitch with Receiver Coupling | ● |
| 12" Electric Brakes & Manual Handbrake | ● |

SUSPENSION

| | |
|---|---|
| Off Road Independent Suspension System | ● |
| Heavy Duty Coil Springs & Shock Absorbers | ● |

STORAGE

| | |
|---|---|
| 1 x Large Front Toolbox | ● |
| Dedicated Fridge Slides with Power Supply | ● |
| 12+ Interior Storage Cupboards & Drawers | ● |
| 2 x 9kg Gas Bottle Holders | ● |
| 2 x 20L Jerry Can Holders | ● |

KITCHEN & BATHROOM

| | |
|---|---|
| Interior & Exterior Thetford 3 Burner Cooktops with Lighting & Gas Plumbing Connections. | ● |
| 2 x 95L Fresh Water Tanks | ● |
| 125L Grey Water Tank | ● |
| Interior Built in Fridge / Freezer | ● |
| Interior Built in Microwave | ● |
| External Shower Outlet | ● |
| Installed On Board Gas/Elec Hot Water Unit | ● |
| Large Vanity Mirror Inside Ensuite Area | ● |
| Thetford Cassette Toilet | ● |
| Interior Ensuite shower Room with Movable Rose Head, Corner Sink, Roof Ventilation, LED Lighting & Mirror | ● |

SAFETY

| | |
|--|---|
| Fire Extinguisher Included | ● |
| ADR Approved Safety Chains & Coupling | ● |
| Dual Internal Smoke and Carbon Monoxide Alarms | ● |
| Reversing Camera Included | ● |

EXTERIOR GENERAL

| | |
|--|---|
| Fibreglass Body with Aluminum Internal Supports | ● |
| Black Heavy Duty Lower Body Coating | ● |
| Entry Door with Separate Screen Door | ● |
| 3.9m x 2.3m Electric Sunshade Awning with LED Lighting | ● |
| Fold Down Serving / Picnic Bench with Lighting | ● |

INTERIOR GENERAL

| | |
|---|---|
| Multimedia Touch Screen Stereo System & 24" Smart TV | ● |
| Dometic Dual System Heating & Cooling Air Conditioner & Diesel Heater | ● |
| Internal & External LED Lighting Throughout | ● |
| Queen Size Main Bed | ● |
| Interior & Exterior Speakers | ● |
| Converting Lounge to Single Bed Space | ● |
| Windows with Block Out & Fly Screen Panels | ● |
| Wood Printed Vinyl Flooring | ● |
| Grey Cabinetry Finishings with Black Handles | ● |
| Built In Sky Light Hatch with LED Lighting | ● |

POWER

| | |
|---|---|
| REDARC Battery Management System with Solar Reg, Charging, & Bluetooth Controls | ● |
| Anderson Plug Car Connections | ● |
| 2 x 150ah Lithium Batteries | ● |
| Dual 200w Roof Mounted Solar Panels | ● |
| 3000 WATT - 12v / 240v Inverter System | ● |
| 240V Connection with Multiple GPO Points | ● |
| Multiple 12V Sockets with Dedicated Fridge Sockets | ● |

CAMPING ACCESSORIES

| | |
|------------------------------|---|
| 62L Dual Zone Fridge Freezer | ○ |
| 2KVA Generator | ○ |

● Standard ○ Optional Upgrades

* Data accurate at time of print, please visit website product listing for more unit specifications & most current information.

** Weights are indicative and subject to change. The build specification will change the weight. Actual weights will be displayed on compliance plates at time of build. Pods only have diesel heater but other models have both Dometic aircon/diesel heaters

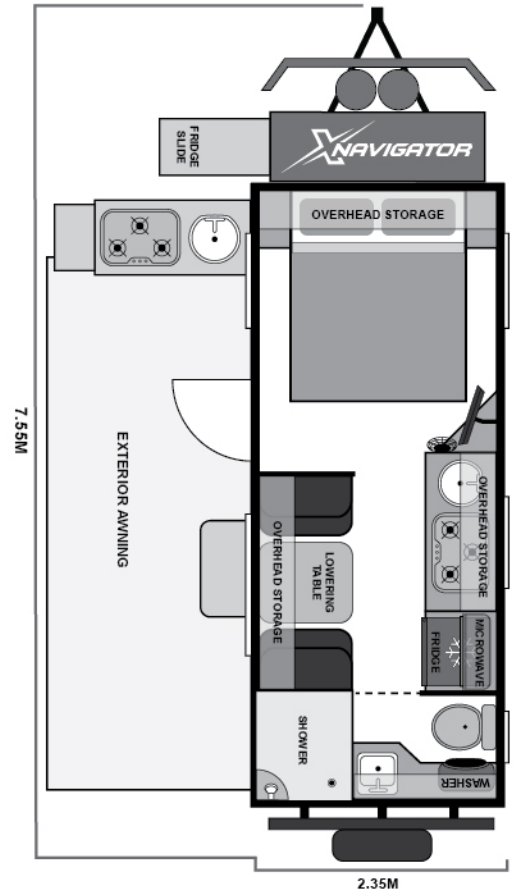

SIZE CLOSED - INCLUDES A/C
Length 7.55m - Width 2.35m - Height 3.1m



ATM

APPROX.
2850KG



TARE

APPROX.
2300KG



BALL WEIGHT

APPROX.
200KG



CHARGER SYSTEM

REDARC POWER
SYSTEM & INVERTER



BATTERY

2 x 150AH
LITHIUM



POWER

240V CONNECTION
INCLUDED



WATER TANKS

2 x 95L CLEAN
1 x 125L GREY



HEATING & COOLING

DOMETIC DUAL SYSTEM
INC. & DIESEL HEATER



CAPACITY

2 ADULTS
1 CHILD



GAS & JERRY HOLDERS

2 x 9KG GAS
2 x 20L JERRY